

Inline Water Pump VP40R

Application

- Solar water heater circulation.
- Domestic heat pump water heater.
- Other Pipeline booster..
- Other machine hot water circulation etc.

Feature

- Can endure 100°C high temperature.
- Over temperature and over voltage protection.
- Closed impeller,high pressure.
- PWM/0~5V Speed control function [optional].



Parameter

Parameter (only for reference, it can be customized)

Model	Voltage V	Rated Current A	Max flow L/MIN	Max head M	Power W
VP40R	12	2.2	19	7	25
	12	2.2	19	7	25
	24	2.1	24	10	50
	24	2.1	24	10	50

Remarks: The parameters above are for reference only, the one based on the customer's endorsement demands shall prevail!

Specification

NO	Items	Specs
1	Sizes	144.2x52x52; weight 500g
2	Dimension of inlet	Thread nozzles: G1/2
3	Dimension of outlet	Thread nozzles: G1/2
4	Pump material	PPS
5	Condition of use	Continuously
6	Fluids	Water, anti-freeze fluid.
7	Ambient temperature	-25~70°C
8	Max fluid temperature	-20~100°C
9	Power consumption	25W~52W
10	Rated voltage	12V/24Vdc
11	Voltage used	8Vdc ~ 20Vdc , 12Vdc ~ 30Vdc
12	Noise	<45dB
13	Water proof class	IP68 (Submersible installed optional)
14	Life span	More than 20000hrs
15	Power supply	Solar panel; DC electric source; battery

Notice

- Runs in the condition of the pump chamber without liquid is not allowed.
- Reversely connects the power polarity is not allowed.
- Filter measures should be taken when used in foul water environment.
- Runs in the acid and alkali environment is not allowed.
- Ambient temperature and fluid temperature should be within the rated temperature.

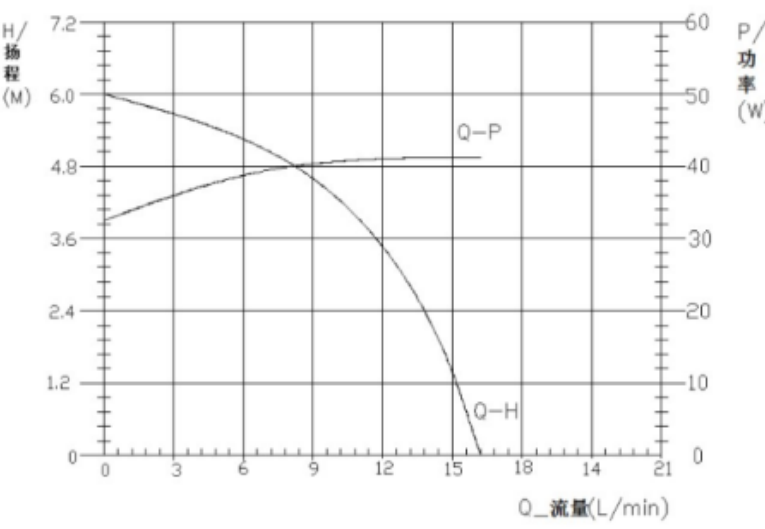
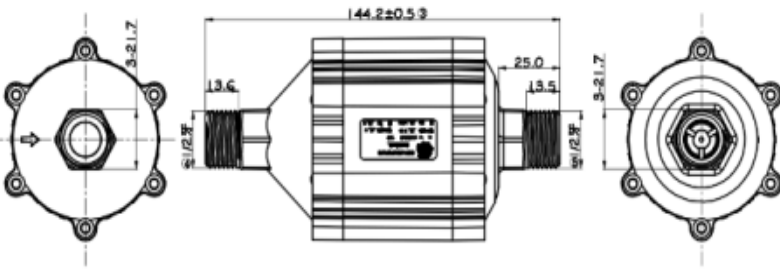

Dimension

Head-Flow curve graph