

# Intelligent Toilet Water Pump VP60H

## Application

- Intelligent toilet
- Air energy water heater
- Solar water heater
- Household and commercial straight drinking machine
- Constant temperature gas water heater boost
- Other water circulation equipment.

## Feature

- Can endure 100°C high temperature.
- Ceramic sleeve ceramic shaft Long life Low noise. rotation clogging protection .
- Closed impeller, high pressure.
- Lack water protect function.
- PWM/0~5V speed control function [optional].



## Parameter

Parameter (only for reference, it can be customized)

Model	Voltage V	Rated Current A	Max flow L/MIN	Max head M	Power W
VP60H	24	3.1	22	14.5	75
	24	3.1	22	14.5	75
	24	3.1	22	14.5	75
	24	3.1	22	14.5	75

Remarks: The parameters above are for reference only, the one based on the customer's endorsement demands shall prevail!

## Specification

NO	Items	Specs
1	Sizes	95.4x95.8x60 weight 0.46kg
2	Dimension of inlet	G 3/4 inch thread
3	Dimension of outlet	G 3/4 inch thread
4	Pump material	PPE
5	Condition of use	Continuously
6	Fluids	Water, oil, antifreeze
7	Ambient temperature	-25~70°C
8	Max fluid temperature	0~100°C
9	Power consumption	75W
10	Rated voltage	24V dc
11	Voltage used	12Vdc ~ 30Vdc
12	Noise	<45dB
13	Water proof class	IP68
14	Life span	More than 20000hrs
15	Power supply	Solar panel; DC electric source; battery

## Notice

- Runs in the condition of the pump chamber without liquid is not allowed.
- Reversely connects the power polarity is not allowed.
- Filter measures should be taken when used in foul water environment.
- Runs in the acid and alkali environment is not allowed.
- Ambient temperature and fluid temperature should be within the rated temperature.

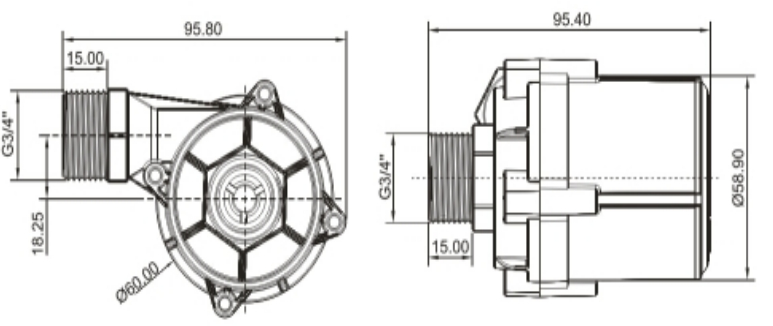

Dimension

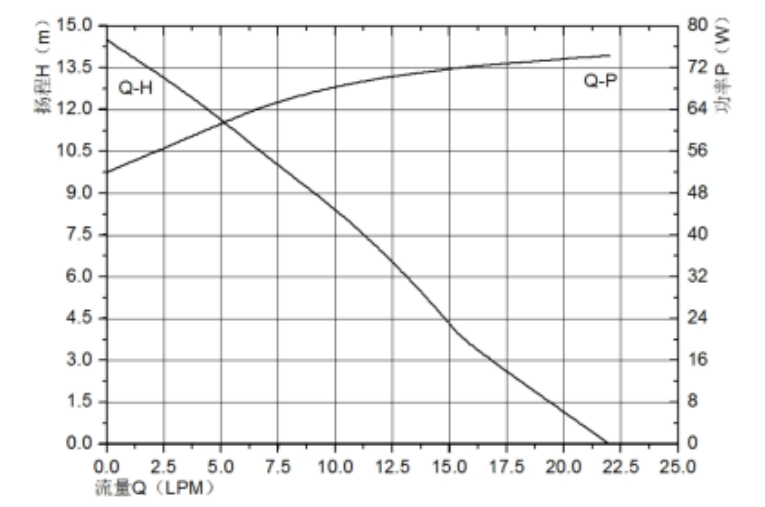

Head-Flow curve graph